

UNDERCURRENTS

Exchange is a living process of transformation, like conversations that span across generations.

To share and ignite the spirit kept alive between ancient and living relations.

Our hearts beat the songs of thousands of generations, guided in haptic practice, and embedded and encoded in our exchanges.

About the Exhibition:

The exhibition explores the Undercurrents of Country, by using forms that speak in relation to each other, inquiring about permanence and ephemerality through reflective narratives between sky and land. The artist has used both immersive and intimate forms, including a woven constellation installation, paintings, soundscapes, and ceramic vessels to provide a material sensibility reflecting on place and identity.

About the Artist:

Jody Rallah is a yuggera/yugggerabul and biri/bindal artist from Brisbane whose diverse practice encompasses object making and painting, sculptural installation, facade and thoroughfares, soundscape, and collaborative approaches. She creates “knowledge vessels” to investigate how the aliveness of place is encoded in memory spaces, relationships, and haptic processes. Through art-making practices, Rallah explores the echo between generations on Country, identity, and the contemporary conditions that can influence our relationships with Country and each other. Rallah is passionate about re-embedding First Nations knowledge spaces back into the built environment by collaborating with Elders and organisations, to create spaces and vessels that are inviting and alive with movement, memory, and narratives.

Genevieve Trace - Executive Director | Annelize Mulder - Curator (Exhibition Program)

metroarts.com.au | info@metroarts.com.au | 07 3002 7100
97 Boundary Street, West End Qld 4101
Find us on Facebook and Instagram

Metro Arts acknowledge the Jagera and Turrbal peoples, as the custodians of the land we work on, recognising their connection to land, waters and community. We honour the story-telling and art-making at the heart of First Nations' cultures, and the enrichment it gives to the lives of all Australians.

Metro Arts



GALLERY ONE

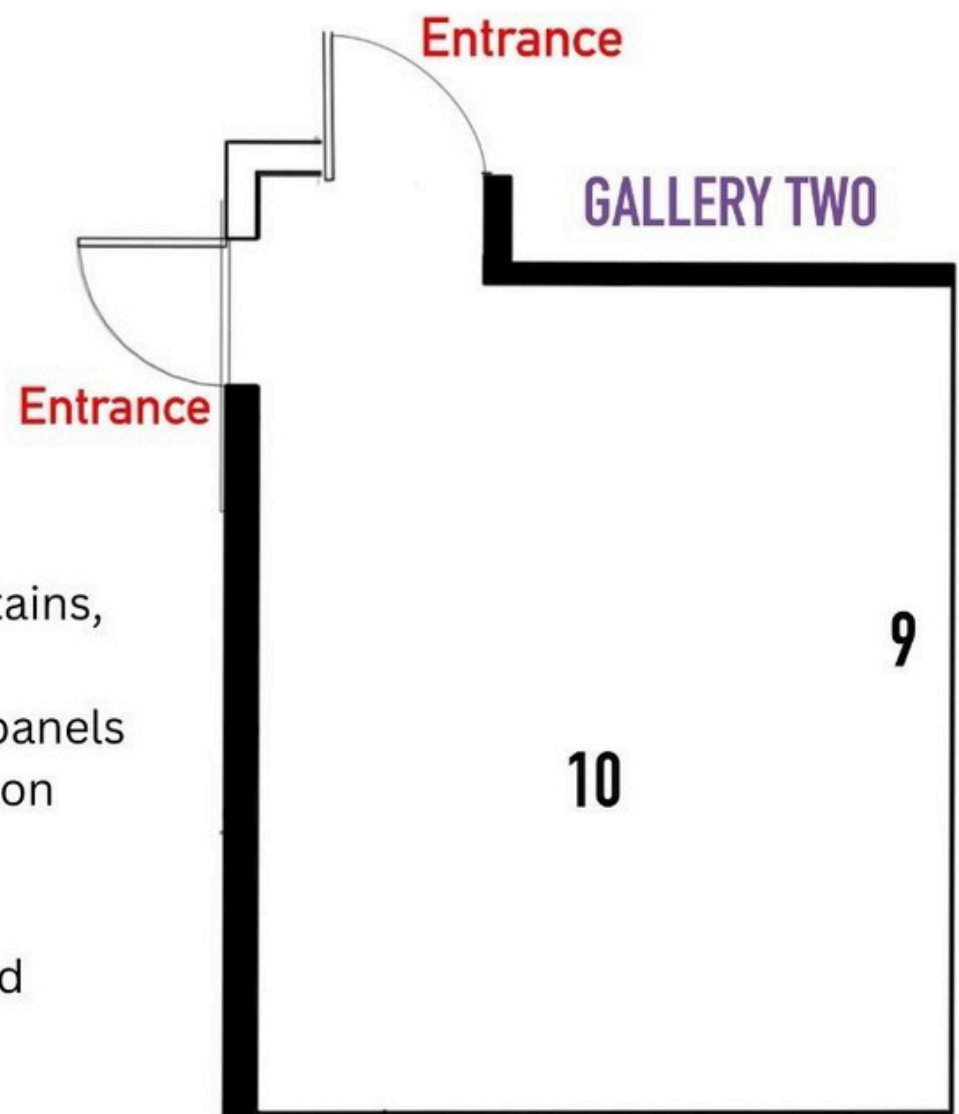
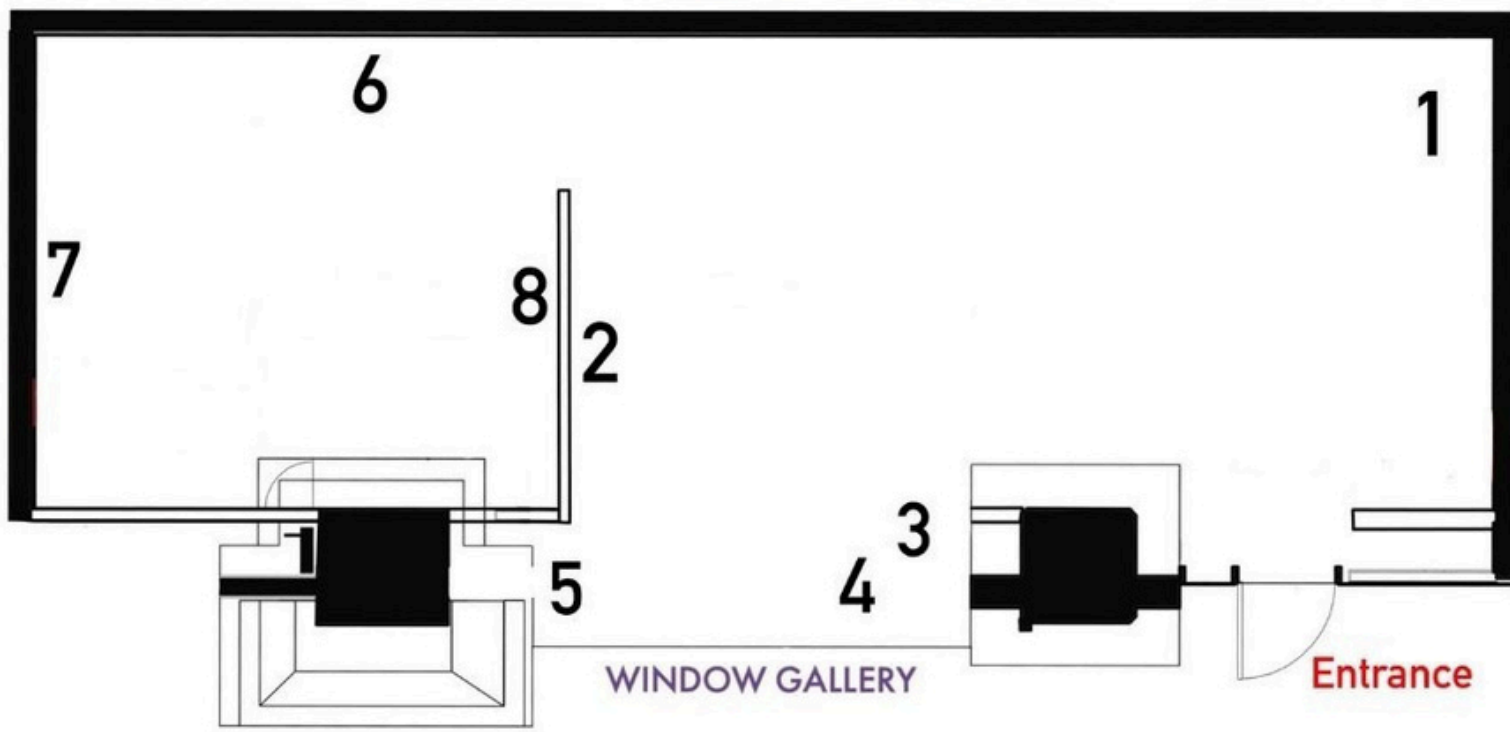

Gallery One

1. Movement Map - Painted clay river made of mountains, 2023, Clay, sand, and Ceramic Coolamons
2. Path to the Waterhole, 2022, CNC routed polymer panels
3. Stars moving across the sky, 2023, Ceramic coolamon
4. Chidna, 2023, Ceramic Coolamom
5. Out of the archive, 2019, Black archival boxes
6. My Country - Mountian Metaphors, 2023, Ochre and binder on canvas
7. Star etchings, 2023, Acrylic on Linen and canvas
8. Ingredients to Wealth, 2019, Acrylic and Gold leaf on Linen (on loan from St. Vincents Hospital collection)

Gallery Two

9. Enogera Clay Textures Composition, 2022, CNC routed polymer panels
10. Guides, 2021 - 2023, Reclaimed copper

Soundscape